



## ER 9 V

Lithium-thionyl Chloride  
(Li-SOCl<sub>2</sub>) Battery

### Pack construction

**3 ER14250C  
in series**

● Pack designation 9V

### Electrical characteristics

*( Typical values for cells stored for one year or less, at 25°C )*

● Nominal capacity 1.2Ah

(At 1.5mA, +25°C, 6.0V cut off. The capacity restored by the cell varies according to current drain, temperature and cut off voltage.)

● Open circuit voltage (at +20°C) 11V

● Nominal voltage (at +20°C and 1.5mA) 9V

● **Maximum recommended continuous current** 15mA  
Higher currents possible, consult EVE.)

● **Storage** (recommended) 30°C max

● **Operating temperature range** -40°C~+85°C  
(Operation at temperature different from ambient may lead to reduced capacity and lower voltage plateau readings.)

● **Typical weight** 31g

### KEY FEATURES

- ✓ High and stable operating voltage
- ✓ High minimum voltage during pulsing
- ✓ Low self discharge rate (less than 1% after 1 year of storage at +25°C)
- ✓ Stainless steel container
- ✓ Hermetic glass-to-metal sealing
- ✓ Non-flammable electrolyte
- ✓ Compliant with IEC 86-4 safety standard and EN 50020 intrinsic safety
- UL Underwriters Laboratories (UL) component Recognition (File Number MH 28717)

### MAIN APPLICATIONS

- ✓ Utility metering
- ✓ Alarms and security devices
- ✓ Memory back-up
- ✓ Smoke detectors
- ✓ Industrial electronics
- ✓ Medical equipment ... etc.

#### ⚠ WARNING:

Fire, explosion and severe burn hazard. Do not recharge, crush, disassemble, heat above 100°C, incinerate, or expose contents to water. Do not solder directly to the cell.

Note: Any representations in this brochure concerning performance, are for informational purposes only and are not construed as warranties either expressed or implied, of future performance.

# ER 9 V battery pack

Voltage versus Current at +20 °C (at mid-discharge)

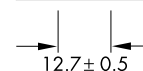
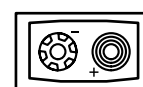
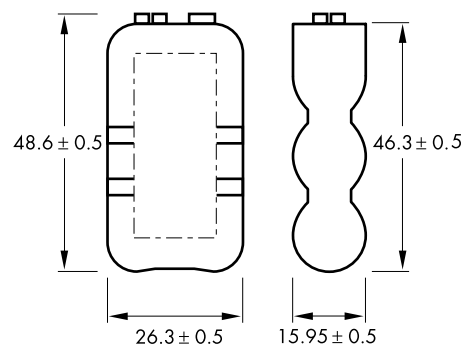
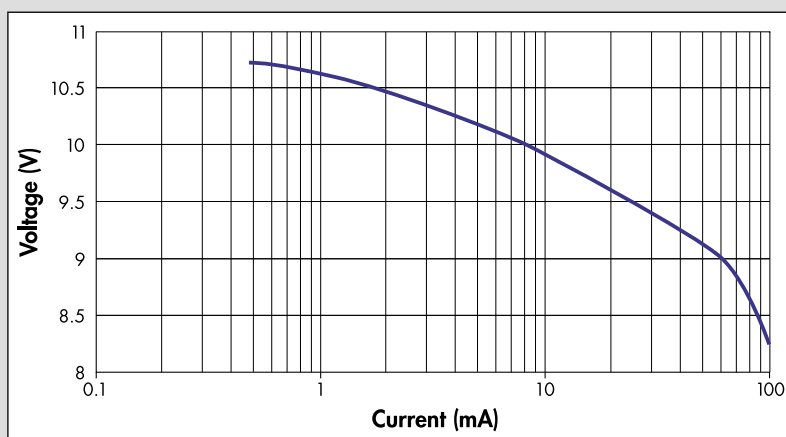

dimensions in mm

Restored Capacity versus Current at +20 °C (6 V cut off)

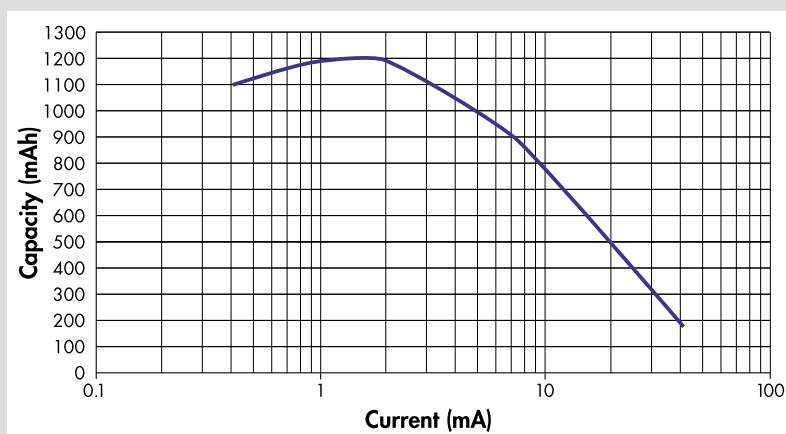

Information in this document is subject to change without notice and becomes contractual only after written confirmation by EVE.